

FRUITION[®] NOVA[®] GARDEN

FRUIT FLY LURES & TRAP (2 PACK)

Instructions for Trap Assembly

① Each Fruition Nova Garden trap consists of:

- ✓ 2 x Fruition yellow discs
- ✓ 1 x metal clip
- ✓ 1 x Fruition lure sachet (blue)
- ✓ 1 x Natflav 500 sachet (brown)
- ✓ 1 x soft wire tie

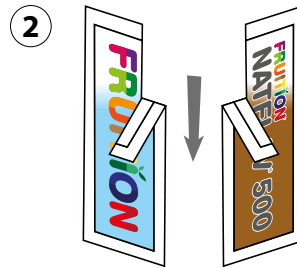

To assemble a Fruition Nova Garden trap, tear open each sachet (one blue, one brown) approximately 20 mm where indicated, leaving torn segment attached. Set each sachet aside.

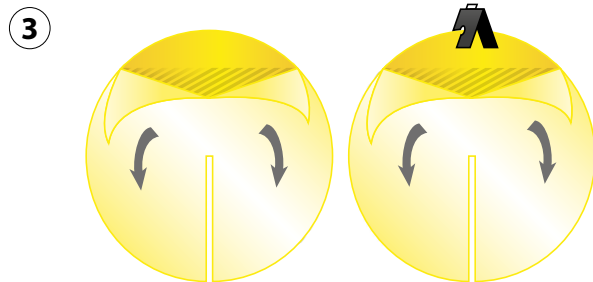

Holding discs by non-adhesive areas at either top or bottom, remove all paper on both sides ensuring sticky surfaces do not come into contact with other surfaces.

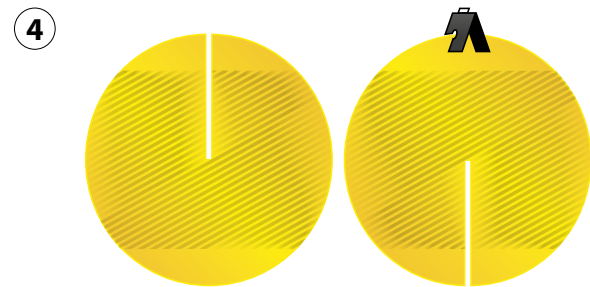

Arrange discs with slots opposing each other.

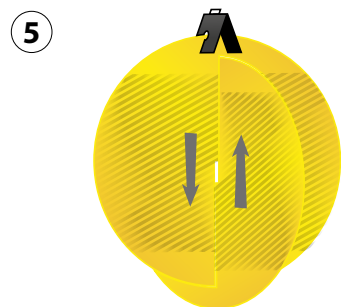

Slot discs together.

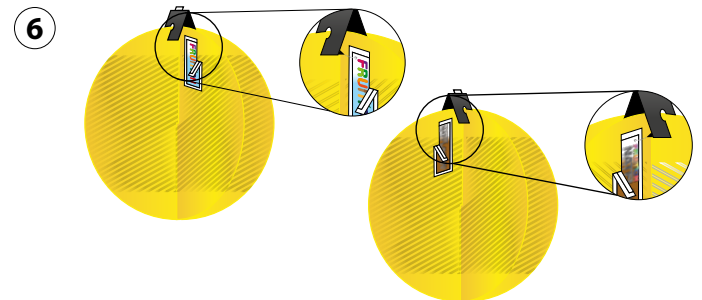

Place each sachet (one blue, one brown) on disc so each spike on clip will pierce each sachet, then pierce disc, when squeezed closed.

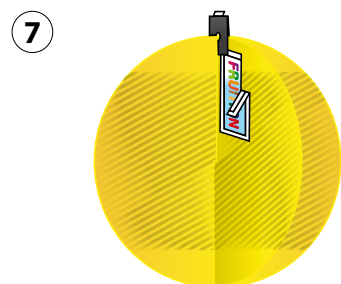

Squeeze both sides of clip simultaneously to close **FIRMLY** so that both sachets are secured and spikes penetrate through opposite side of disc. Fold up spikes for extra security.

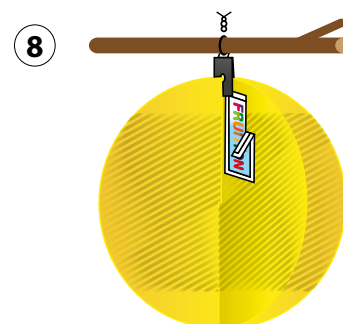

Thread tie through eyelet in clip and hang trap securely in desired location.

FRUITION® NOVA® GARDEN

FRUIT FLY LURES & TRAP (2 PACK)



Trap Assembly Guide

Fruition® Nova® Garden Fruit Fly Lures & Traps are specifically designed to attract and trap pest fruit flies in the home garden using a unique combination of trap shape and colour, and attractant lures.

One part of the lure system is designed to attract egg-laying female fruit flies to the trap. This is a unique lure designed and developed by the International Centre for Management of Pest Fruit Flies at Griffith University in Brisbane. The second lure is a protein bait which attracts immature male and female fruit flies to the trap, removing them from the garden before they have the opportunity to mate and lay eggs.

The design of the Fruition Nova Garden Fruit Fly Lures & Trap is the same as the trap widely used in commercial fruit and vegetable crops to manage fruit fly populations and reduce crop damage.

Fruition Nova Garden Fruit Fly Lures use naturally-occurring ingredients. Fruition Nova Garden Fruit Fly Traps are non-toxic and pesticide-free.

Fruition Nova Garden Fruit Fly Lures & Traps attract and trap all of the main pest species of fruit fly, including Queensland fruit fly (*Bactrocera tryoni*), lesser Queensland fruit fly (*Bactrocera neohumeralis*), Jarvis' fruit fly (*Bactrocera jarvisi*), cucumber fruit fly (*Bactrocera cucumis*), and Mediterranean fruit fly (*Ceratitidis capitata*).

Use Recommendations

1. Fruition Nova Garden Fruit Fly Lures & Traps are effective for up to 12 weeks.
2. Fruition Nova Garden Fruit Fly Lures & Traps should be deployed before fruit becomes attractive to fruit flies, generally when fruit is hard and green, before it begins to ripen.
3. Use one trap per tree for trees up to 3 m in height and two traps per tree for larger trees.
4. In fruit trees, hang traps at a height of 1.5–2 m above ground. For trees up to 3 m in height, hang the trap on the northern side of the tree in the outer part of the canopy where the trap is visible but not exposed to constant sunlight. In addition, for trees greater than 3 m in height, hang a second trap on the southern side of the tree.
5. In vegetable crops, secure the trap to a tomato stake or similar rigid support at a height just above the canopy of the crop. Use one trap per 10 m x 10 m area.
6. Replace the trap if the discs become densely covered in fruit flies or the lure sachets have been opened for more than 12 weeks.
7. Avoid contact with the adhesive surface of the trap. The adhesive is non-toxic and can be removed from skin using vegetable oil.
8. Disassemble used traps at the end of the season and dispose of the components through normal domestic waste.